

*SATELLITE SCHOOL TEACHERS BOOTH  
HULHUMALE' CHSE*

*ARCHITECTURAL AND SERVICES DRAWINGS*  
Client: Ministry of Education

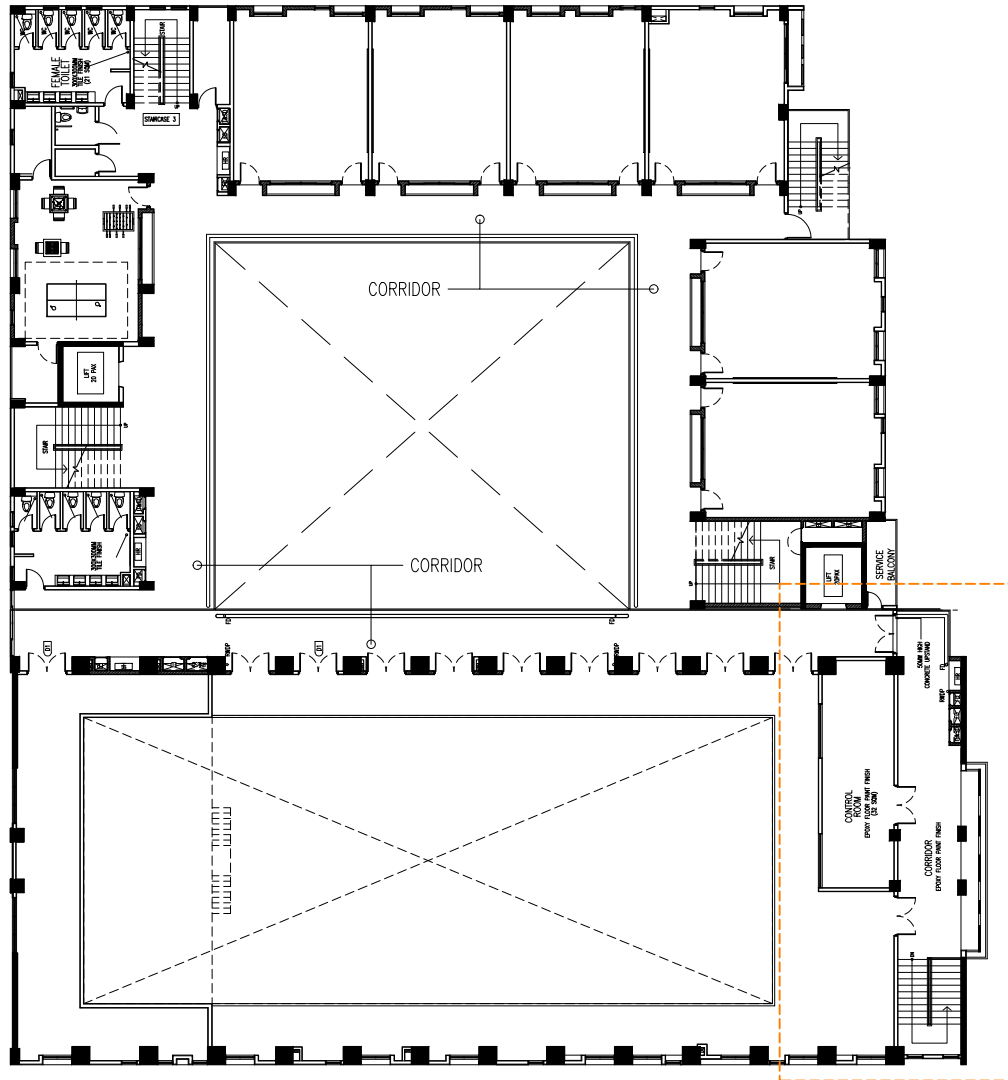

EXISTING  
CHSE - SECOND FLOOR MASTER PLAN  
SCALE 1:200



PROJECT:  
Satellite school Teachers booth  
at Hulhumale ' CHSE

PROJ. REF: \_\_\_\_\_  
SCALE: AS GIVEN  
ARCHITECT: \_\_\_\_\_  
ENGINEER: \_\_\_\_\_  
DRAWN: \_\_\_\_\_  
CHECKED: \_\_\_\_\_  
DATE: 28.10.2025

AMMENDMENTS		
Issue	Date	Description

DWG NO : A01 -14

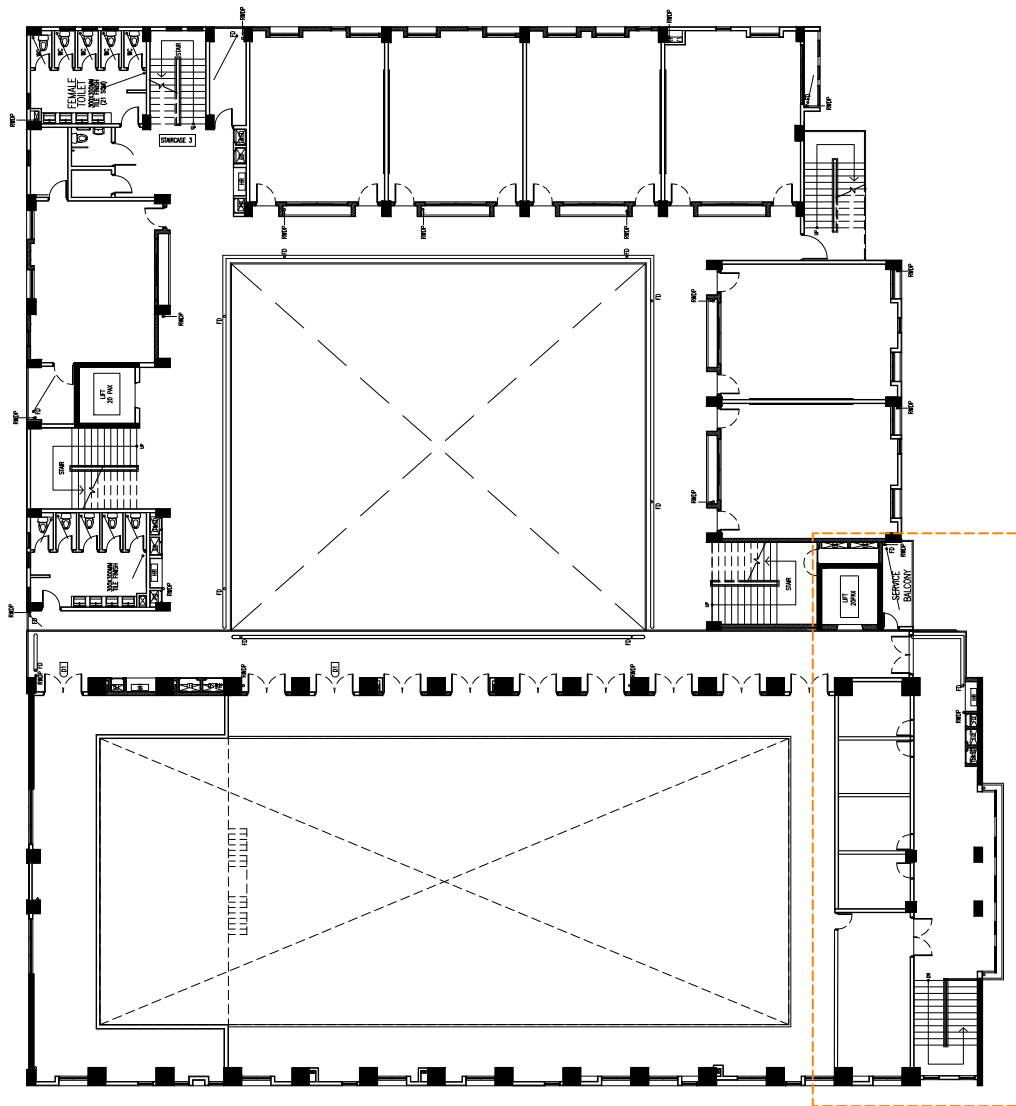

PROPOSED  
**CHSE - SECOND FLOOR MASTER PLAN**  
 SCALE 1:200



PROJECT:  
 Satellite school Teachers booth  
 at Hulhumale ' CHSE

PROJ. REF: \_\_\_\_\_  
 SCALE: AS GIVEN  
 ARCHITECT: \_\_\_\_\_  
 ENGINEER: \_\_\_\_\_  
 DRAWN: \_\_\_\_\_  
 CHECKED: \_\_\_\_\_  
 DATE: 28.10.2025

AMMENDMENTS		
Issue	Date	Description

- NOTE:-
1. All Partition wall shall be finished with acoustic wall panel and height up to ceiling level
  2. Wall with plaster on both side and putty and two coats of paint finished
  3. Fabrication and installation of D1 door
  4. No Change require for D2
- D1
- D2

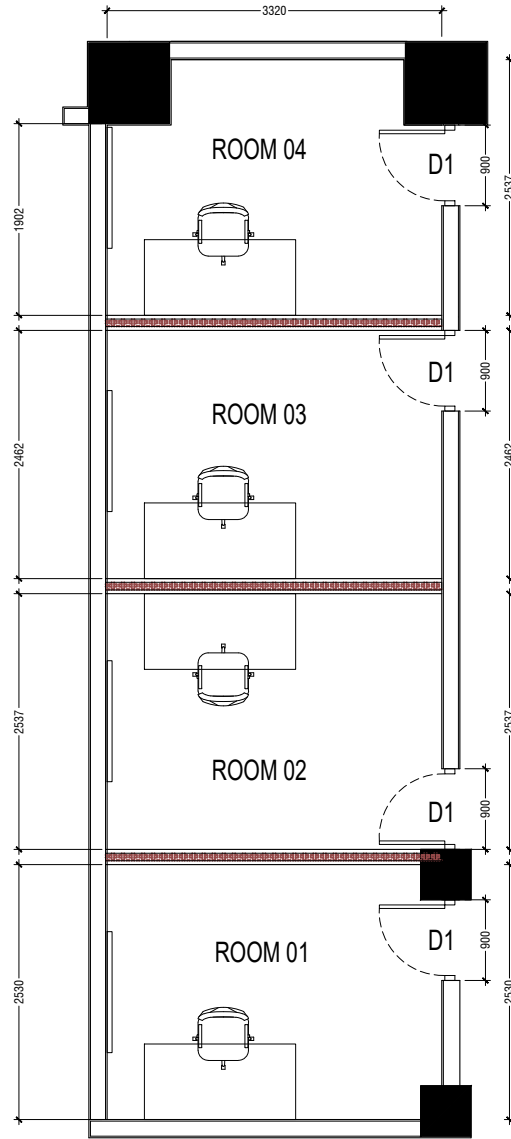

**PROPOSED TEACHERS BOOTH**

SCALE 1:50



PROJECT :  
**Satellite school Teachers booth at Hulhumale ' CHSE**

PROJ. REF: \_\_\_\_\_

SCALE: AS GIVEN

ARCHITECT: \_\_\_\_\_

ENGINEER: \_\_\_\_\_

DRAWN: \_\_\_\_\_

CHECKED: \_\_\_\_\_

DATE: 28.10.2025

AMMENDMENTS		
Issue	Date	Description

DWG NO : A03 -14

- NOTE:-**
1. All Partition wall shall be finished with acoustic wall panel and height up to ceiling level
  2. Wall with plaster on both side and putty and two coats of paint finished
  3. Fabrication and installation of D1 door
  4. No Change require for D2
- D1**
- D2**

New masonry wall with plaster on both side,  
putty finished , two coat of interior white paint.

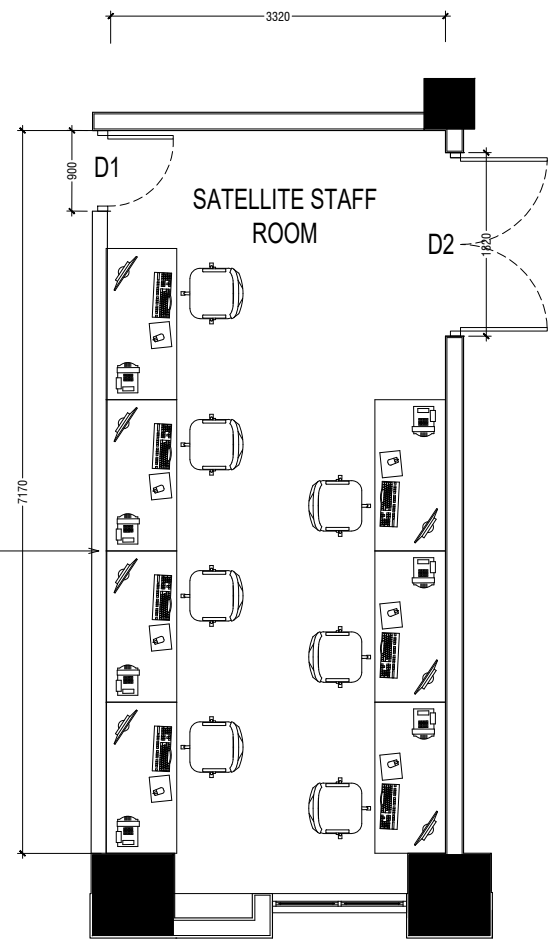

**PROPOSED STAFF ROOM**

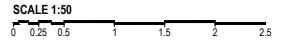

**PROJECT :**  
Satellite school Teachers booth  
at Hulhumale ' CHSE

**PROJ. REF:** \_\_\_\_\_

**SCALE :** AS GIVEN

**ARCHITECT :** \_\_\_\_\_

**ENGINEER :** \_\_\_\_\_

**DRAWN :** \_\_\_\_\_

**CHECKED :** \_\_\_\_\_

**DATE :** 28.10.2025

**AMMENDMENTS**

Issue	Date	Description

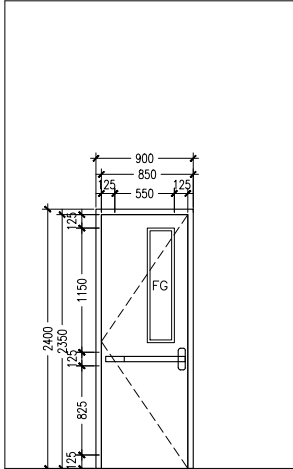

D1
40MM THICK OPENABLE COMPOSITE SANDWICH MATERIAL DOOR PANELS
50MM X38MM ALUMINUM FRAME
DOOR CLOSER CYLINDRICAL LOCK BUTT HINGE STOPPER HOLDER
6MM THICK TEMPERED GLASS

**DOOR / WINDOWS**

SCALE 1:50

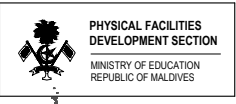

PROJECT :  
**Satellite school Teachers booth  
at Hulhumale ' CHSE**

PROJ. REF: \_\_\_\_\_

SCALE : AS GIVEN

ARCHITECT : \_\_\_\_\_

ENGINEER : \_\_\_\_\_

DRAWN : \_\_\_\_\_

CHECKED : \_\_\_\_\_

DATE : 28.10.2025

AMMENDMENTS		
Issue	Date	Description

DWG NO : A05 -14

NOTE:-  
1. ACOUSTIC CARPETS TILES, The NRC > 0.50.

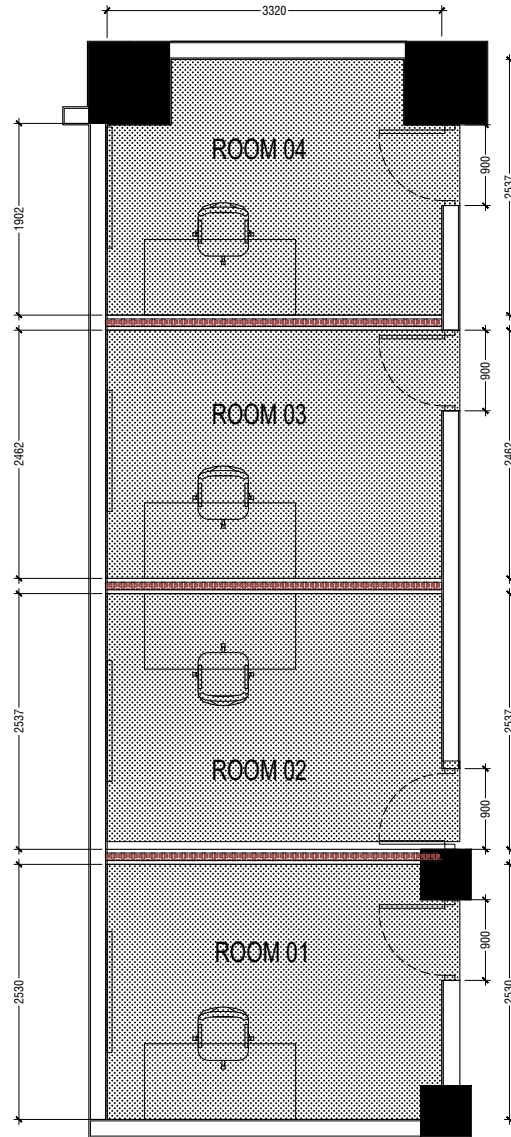

**FLOOR FINISHED**  
**PROPOSED TEACHERS BOOTH**

SCALE 1:50  
0 0.25 0.5 1 1.5 2 2.5



PROJECT :  
**Satellite school Teachers booth at Hulhumale ' CHSE**

PROJ. REF: \_\_\_\_\_  
SCALE: AS GIVEN  
ARCHITECT: \_\_\_\_\_  
ENGINEER: \_\_\_\_\_  
DRAWN: \_\_\_\_\_  
CHECKED: \_\_\_\_\_  
DATE: 28.10.2025

AMMENDMENTS		
Issue	Date	Description

DWG NO : A06 -14



NOTE:-  
1. ACOUSTIC CARPETS TILES, The NRC > 0.50.

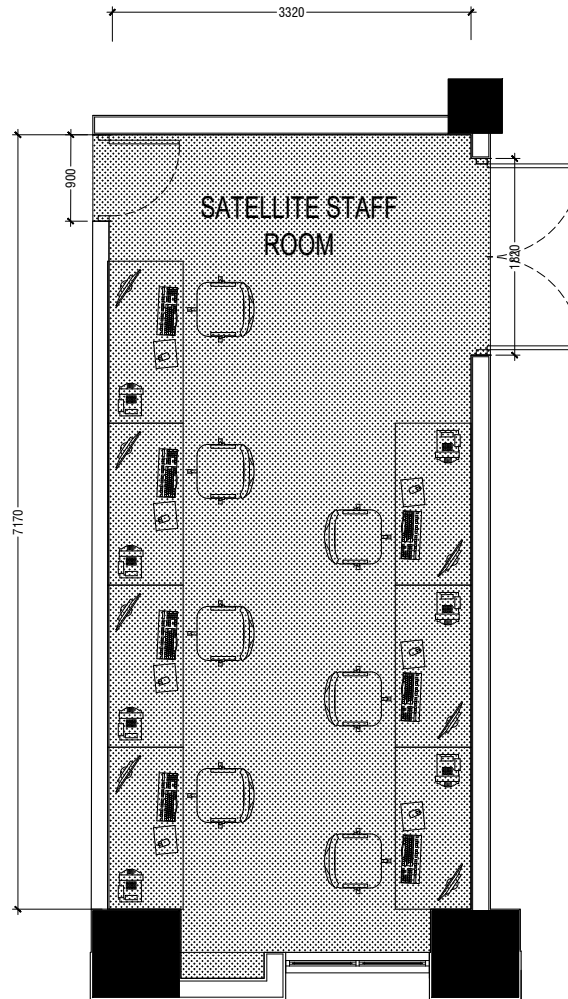

**FLOOR FINISHED**  
**PROPOSED STAFF ROOM**

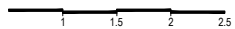

PROJECT :  
**Satellite school Teachers booth**  
at Hulhumale ' CHSE

PROJ. REF: \_\_\_\_\_

SCALE: AS GIVEN

ARCHITECT: \_\_\_\_\_

ENGINEER: \_\_\_\_\_

DRAWN: \_\_\_\_\_

CHECKED: \_\_\_\_\_

DATE: 28.10.2025

**AMMENDMENTS**

Issue	Date	Description

DWG NO : A07 -14

NOTE:-  
 1. SEAMLESS ACOUSTICAL CEILING (80% Noise Reduction Coefficient)

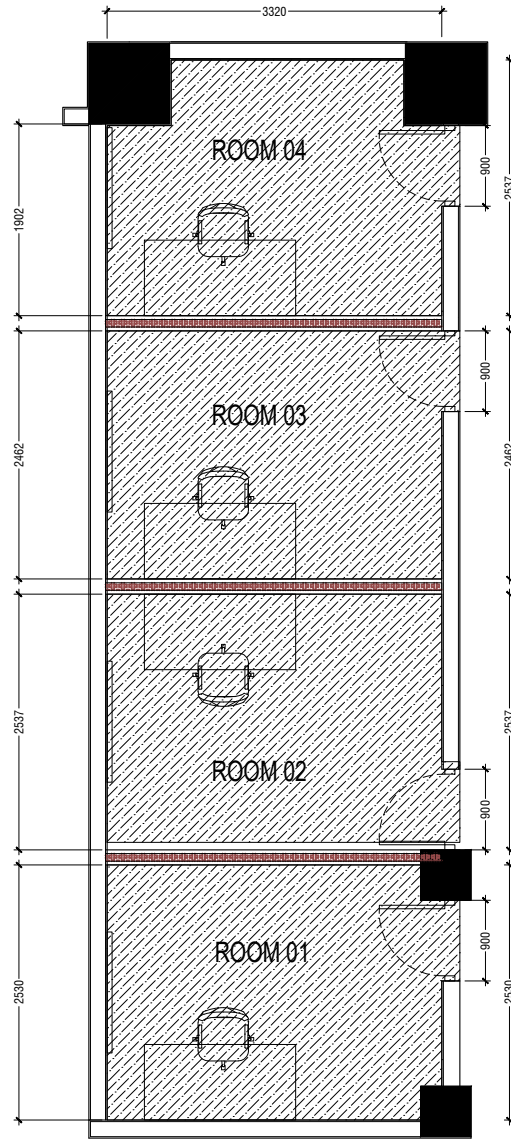

**CEILING FINISHED  
 PROPOSED TEACHERS BOOTH**



PROJECT :  
**Satellite school Teachers booth  
 at Hulhumale ' CHSE**

PROJ. REF: \_\_\_\_\_  
 SCALE: AS GIVEN  
 ARCHITECT: \_\_\_\_\_  
 ENGINEER: \_\_\_\_\_  
 DRAWN: \_\_\_\_\_  
 CHECKED: \_\_\_\_\_  
 DATE: 28.10.2025





AMMENDMENTS

Issue	Date	Description

**NOTE:**

1. ALL WIRING TO BE OF APPROVED STANDARDS
2. ALL THE POWER AND NETWORK SOCKET SHOWN ON FLOOR SHALL BE FIXED ON FLOOR BOXES OR POP UP SOCKET WHEN IT REQUIRE
3. POWER/IT/COMPUTER SOCKETS = 300MM - 450MM FROM FLOOR FIN. LEVEL
4. SWITCH CONTROL / SOCKET = 1100MM - 1200MM FROM FLOOR FIN. LEVEL
5. KITCHEN SOCKETS / PANTRY SOCKETS = 1150MM - 1250MM FROM FLOOR FIN. LEVEL
6. AC = 2500MM - 2700MM FROM FLOOR FIN. LEVEL

**LEGEND**

-  DISTRIBUTION BOX
-  13A POWER OUTLET
-  13A TWIN SOCKET OUTLET
-  15A SWITCHED/ SPUR UNIT @ H.L.

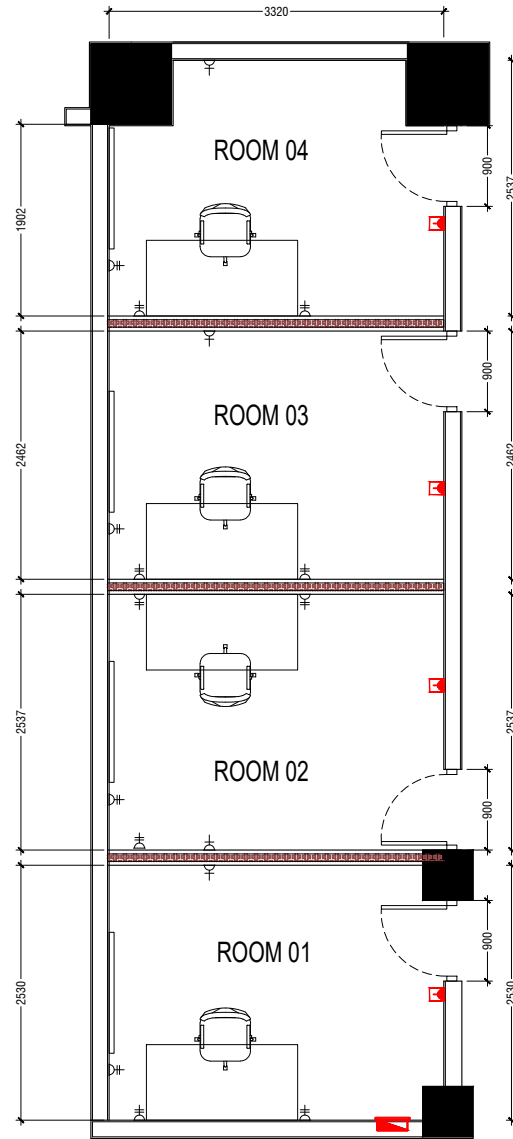

**PROPOSED POWER LAYOUT  
PROPOSED TEACHERS BOOTH**

SCALE 1:50  
0 0.25 0.5 1 1.5 2 2.5



**PROJECT :**  
Satellite school Teachers booth  
at Hulhumale ' CHSE

**PROJ. REF:** \_\_\_\_\_  
**SCALE :** AS GIVEN  
**ARCHITECT :** \_\_\_\_\_  
**ENGINEER :** \_\_\_\_\_  
**DRAWN :** \_\_\_\_\_  
**CHECKED :** \_\_\_\_\_  
**DATE :** 28.10.2025





AMMENDMENTS		
Issue	Date	Description

DWG NO : A09 -14

**NOTE:**

1. ALL WIRING TO BE OF APPROVED STANDARDS
2. ALL THE POWER AND NETWORK SOCKET SHOWN ON FLOOR SHALL BE FIXED ON FLOOR BOXES OR POP UP SOCKET WHEN IT REQUIRE
3. POWER/IT/COMPUTER SOCKETS = 300MM - 450MM FROM FLOOR FIN. LEVEL
4. SWITCH CONTROL / SOCKET = 1100MM - 1200MM FROM FLOOR FIN. LEVEL
5. KITCHEN SOCKETS / PANTRY SOCKETS = 1150MM - 1250MM FROM FLOOR FIN. LEVEL
6. AC = 2500MM - 2700MM FROM FLOOR FIN. LEVEL

**LEGEND**

-  DISTRIBUTION BOX
-  13A POWER OUTLET
-  13A TWIN SOCKET OUTLET
-  15A-SWITCHED/ SPUR UNIT @ H.L.

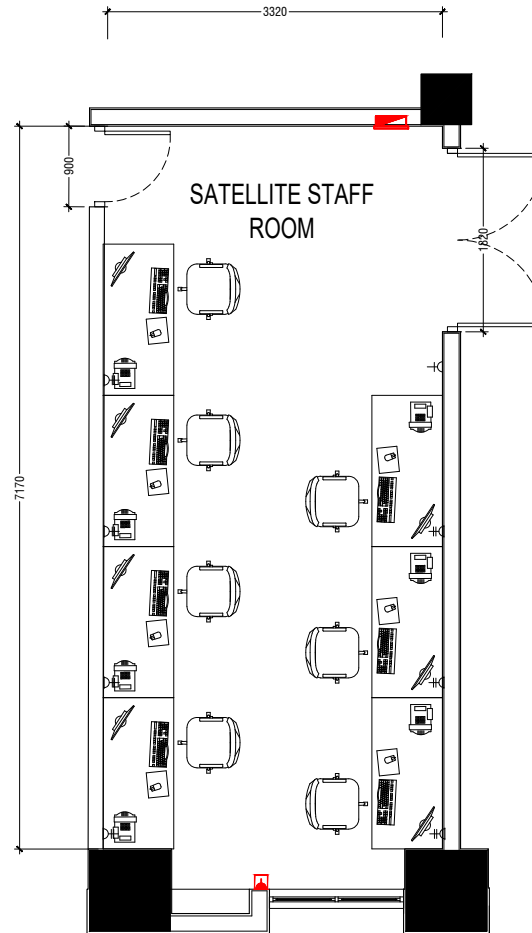

**PROPOSED POWER LAYOUT  
PROPOSED STAFF ROOM**

SCALE 1:50  
0 0.25 0.5 1 1.5 2 2.5



**PROJECT :**  
Satellite school Teachers booth  
at Hulhumale ' CHSE

**PROJ. REF:** \_\_\_\_\_

**SCALE :** AS GIVEN

**ARCHITECT :** \_\_\_\_\_

**ENGINEER :** \_\_\_\_\_

**DRAWN :** \_\_\_\_\_

**CHECKED :** \_\_\_\_\_

**DATE :** 28.10.2025

**AMMENDMENTS**









Issue	Date	Description

DWG NO : A10 -14

**NOTE:**

- ALL WIRING TO BE OF STELCO APPROVED STANDARDS
- SWITCH CONTROL = 1200MM FROM FLOOR FIN. LEVEL
- ALL LIGHTING POINTS CONNECTED TO THEIR RESPECTIVE DB
- POLYCARBONATE ENCLOSURE TO ALL SWITCH AND SOCKET WHICH ARE LOCATED AT THE OUTDOORS

**LEGEND**

- SL  600x600mm LED PANEL 25W
- H2  LED RECESSED DOWN LIGHT 12W
- CL  LED CEILING LIGHT 18W
- C2  LED CEILING DOWN LIGHT ( 18W)
-  LIGHT SWITCH
-  SWITCHING LINE
-  EXHAUST FAN (CEILING MOUNTED)
- EM  EMERGENCY LIGHT

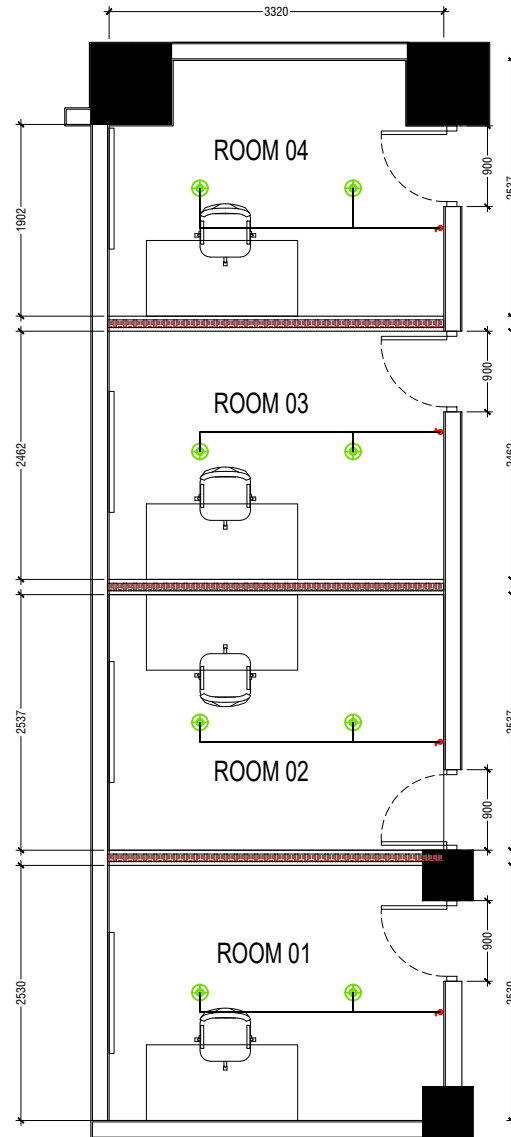

**LIGHT LAYOUT  
PROPOSED TEACHERS BOOTH**

SCALE 1:50  
0 0.25 0.5 1 1.5 2 2.5



**PROJECT :**  
Satellite school Teachers booth  
at Hulhumale ' CHSE

**PROJ. REF:** \_\_\_\_\_  
**SCALE :** AS GIVEN  
**ARCHITECT :** \_\_\_\_\_  
**ENGINEER :** \_\_\_\_\_  
**DRAWN :** \_\_\_\_\_  
**CHECKED :** \_\_\_\_\_  
**DATE :** 28.10.2025

AMMENDMENTS		
Issue	Date	Description

DWG NO : A11 -14

**NOTE:**

- ALL WIRING TO BE OF STELCO APPROVED STANDARDS
- SWITCH CONTROL = 1200MM FROM FLOOR FIN. LEVEL
- ALL LIGHTING POINTS CONNECTED TO THEIR RESPECTIVE DB
- POLYCARBONATE ENCLOSURE TO ALL SWITCH AND SOCKET WHICH ARE LOCATED AT THE OUTDOORS

- LEGEND**
- SL 600x600mm LED PANEL 25W
  - H2 LED RECESSED DOWN LIGHT 12W
  - CL LED CEILING LIGHT 18W
  - C2 LED CEILING DOWN LIGHT (18W)
  - LIGHT SWITCH
  - SWITCHING LINE
  - EXHAUST FAN (CEILING MOUNTED)
  - EM EMERGENCY LIGHT

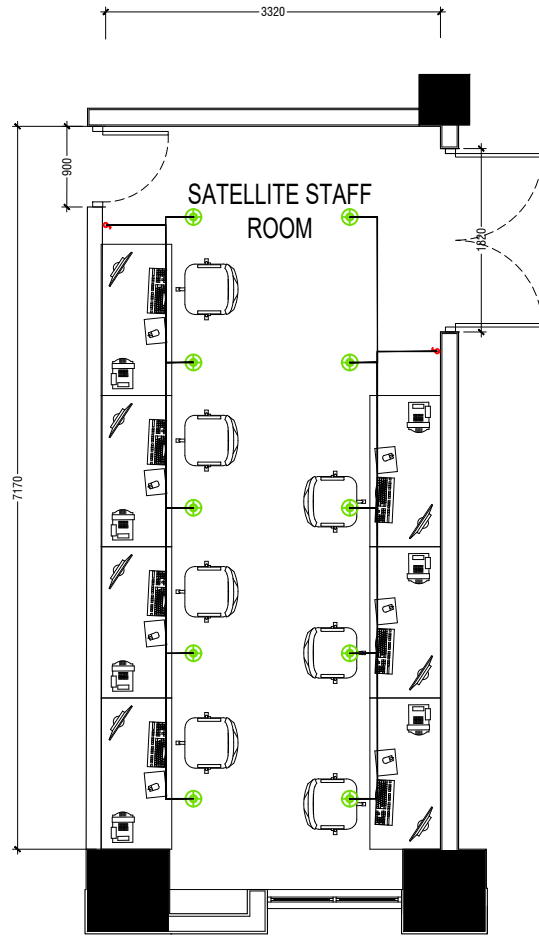

**LIGHT LAYOUT  
PROPOSED STAFF ROOM**

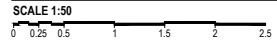

**PROJECT :**  
Satellite school Teachers booth  
at Hulhumale ' CHSE

**PROJ. REF:** \_\_\_\_\_  
**SCALE :** AS GIVEN  
**ARCHITECT :** \_\_\_\_\_  
**ENGINEER :** \_\_\_\_\_  
**DRAWN :** \_\_\_\_\_  
**CHECKED :** \_\_\_\_\_  
**DATE :** 28.10.2025

**AMMENDMENTS**

Issue	Date	Description

NOTE:-  
 1. VRF / VRV system outdoor unit to be install at service balcony with electrical isolator switch as per the power requirement for the VRF / VRV System

VRF/VRV VRF / VRV SYSTEM WITH ISOLATOR UNIT



Ceiling Mount Air Conditioner

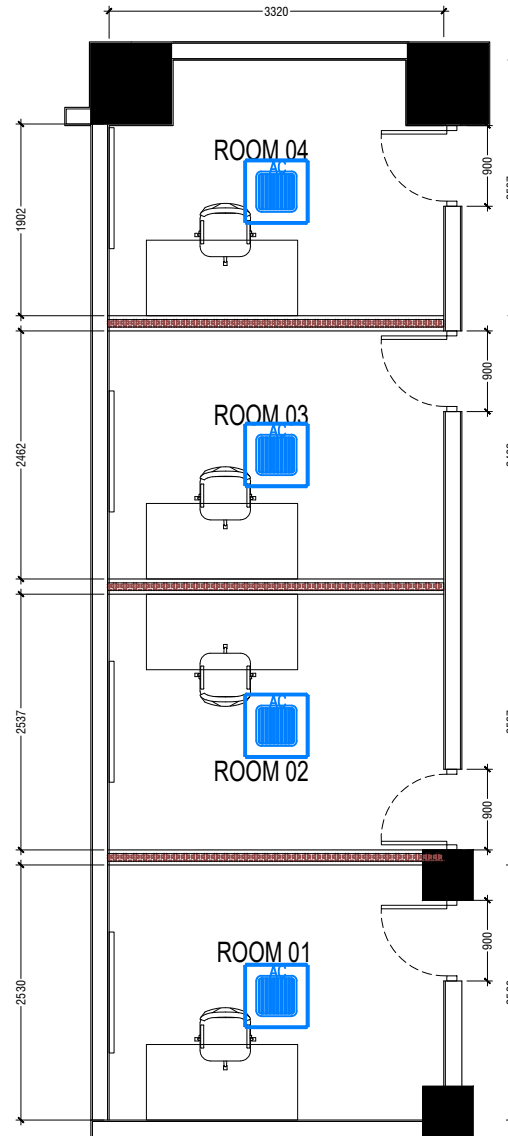

**HVAC PLAN**  
**PROPOSED TEACHERS BOOTH**

SCALE 1:50  
 0 0.25 0.5 1 1.5 2 2.5



PROJECT :  
 Satellite school Teachers booth  
 at Hulhumale ' CHSE

PROJ. REF: \_\_\_\_\_

SCALE: AS GIVEN

ARCHITECT: \_\_\_\_\_

ENGINEER: \_\_\_\_\_

DRAWN: \_\_\_\_\_

CHECKED: \_\_\_\_\_

DATE: 28.10.2025

AMMENDMENTS

Issue	Date	Description

DWG NO : A13 -14

NOTE:-  
 1. VRF / VRV system outdoor unit to be install at service balcony with electrical isolator switch as per the power requirement for the VRF / VRV System

 VRF / VRV SYSTEM WITH ISOLATOR UNIT

 Ceiling Mount Air Conditioner

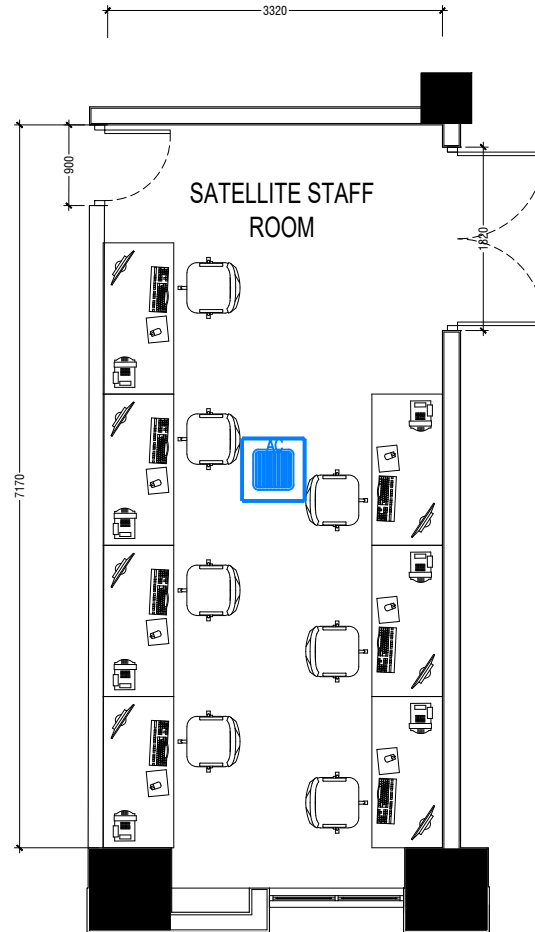

**HVAC PLAN**  
**PROPOSED STAFF ROOM**

SCALE 1:50  
 0 0.25 0.5 1 1.5 2



PROJECT :  
**Satellite school Teachers booth at Hulhumale ' CHSE**

PROJ. REF: \_\_\_\_\_  
 SCALE: AS GIVEN  
 ARCHITECT: \_\_\_\_\_  
 ENGINEER: \_\_\_\_\_  
 DRAWN: \_\_\_\_\_  
 CHECKED: \_\_\_\_\_  
 DATE: 28.10.2025

AMMENDMENTS		
Issue	Date	Description

DWG NO : A14 -14